

There are a number of different typesets and typeholders available for the Hot QuickCoders.

Typeholders are available in 3R Flat, 4R Flat, Concave and Convex versions.

Typesets are available in a Letter set (A-Z), a Number set (0-9) and a Date set (2.5mm size only).



Typeholders and Typesets

## Typeholders

HQC typeholders are inserted into the HQC coding unit using a removable handle.

They have a special ribbed base in order to be able to insert letters, numbers and logos.

The number of lines achievable and the number of characters per line depends on the size of the characters and the number of ribs used on each character.

In general, the 4R Flat holder is the most often used, the 3R, Concave and Convex holders are more for specialty applications



4R flat typeholder



3R flat typeholder



Concave typeholder



Convex typeholder

## Typesets

Typesets are available as Letter Sets, Number sets and a Date set.

All sets have a 2-rib base with the exception of some custom logos (which can be 3-rib) and the Date set (1-rib only). Any other 1-rib sets are custom-made, are not ex-stock and are 30% more expensive.

Sets are available in sizes from 2mm to 5mm, except for the Date set which is available in 2.5mm only (unless custom-made as above)



*1-rib  
Date set 2.5mm characters only*



*2-rib  
All standard sets*

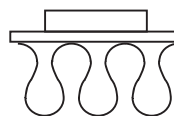

*3-rib  
Special custom-made logos only*

# Type Fitment

It is best to have types centered as much as possible on the holder. When sets are not centered, uneven or unreliable inking may occur.

1 and 2-rib sets can produce multiple lines as per the examples below



4R flat typeholder

Actual Size



Maximum print area: 12 x 24 mm

## Various rib combinations

### 4R holder

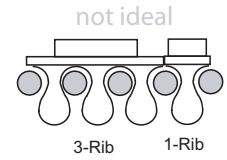
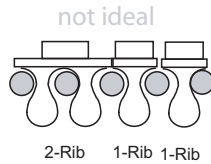
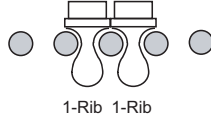
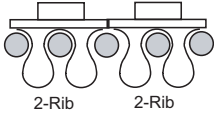

### 3R holder

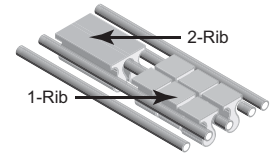
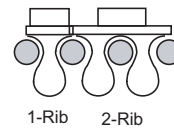
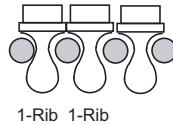
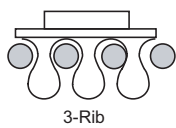

4R combination example

## Examples of 2.5mm messages

### 4R Typeholder

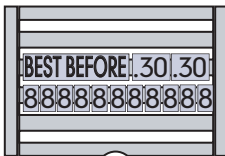

Custom 1-piece "BEST BEFORE" and 1-rib Date set

1-rib Date set individual numbers

BEST BEFORE .30 .30  
888888888888 } Print result

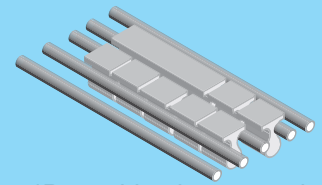

4R combination example

### 4R Typeholder

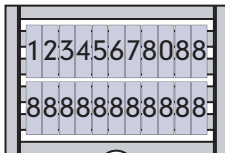

Standard 2-Rib set

12345678088

Standard 2-Rib set

888888888888 } Print result

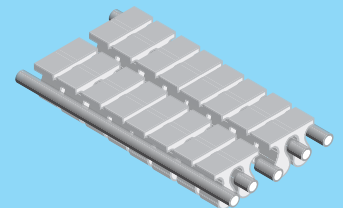

4R combination example

## Quantities in sets

### LETTER (A) set

A	B	C	D	E	F	G	H	I	J	K	L	M	N	O	P	Q	R	S	T	U	V	W	X	Y	Z
7	5	5	5	7	5	5	5	5	5	5	5	5	7	5	5	3	5	5	5	5	5	5	5	3	3
1	2	3	4	5	6	7	8	9	0	.	,	-	/	Ä	Ö	Ü	À	Æ	Ø						
2	2	2	2	2	2	2	2	2	2	1	3	1	1	2	2	2	2	2	2	2	2	2	2	2	2



### NUMBER (C) set

1	2	3	4	5	6	7	8	9	0	.	,	-	/
9	9	9	9	9	9	9	9	9	9	2	3	2	2



### DATE set

A	B	C	D	E	F	G	H	I	J	K	L	M	N	O	P	Q	R	S	T	U	V	W	X	Y	Z
2	2	2	2	2	2	2	2	2	2	2	2	2	2	2	2	2	2	2	2	2	2	2	2	2	2
1	2	3	4	5	6	7	8	9	0	.	,	:	/	08	09	10	11								
2	2	2	2	2	2	2	2	2	2	2	2	2	2	4	4	2	2								
01.	02.	03.	04.	05.	06.	07.	08.	09.	10.	11.	12.														
3	3	3	3	3	3	3	3	3	3	3	3														
13.	14.	15.	16.	17.	18.	19.	20.	21.	22.	23.	24.	25.	26.	27.	28.	29.	30.	31.							
2	2	2	2	2	2	2	2	2	2	2	2	2	2	2	2	2	2	2	2	2	2	2	2	2	2



Spacer  
2x 90mm